

Table 3 Piston Rod End Styles (Series H, LH and A) See page 105 for Series MN

ROD MM	A	B	-001 -003	C	CC	*D	KK ₁	KK _{2 3 5}	NA	AD	AE	+001 -002	AF diameter	AC
5/8	3/4	1 1/8		3/8	5/8-18	1/2	1/2-20	7/16-20	19/32	5/8	1/4		3/8	1 1/8
1	1 1/8	1 1/2		1/2	1-14	7/8	7/8-14	3/4-16	31/32	15/16	3/8		11/16	1 1/2 (#1)
1 3/8	1 5/8	2		5/8	1 3/8-12	1 1/8	1 1/4-12	1-14	1 11/32	1 1/16	3/8		7/8	1 3/4
1 3/4	2	2 3/8		3/4	1 3/4-12	1 1/2	1 1/2-12	1 1/4-12	1 45/64	1 5/16	1/2		1 1/8	2
2	2 1/4	2 5/8		7/8	2-12	1 11/16	1 3/4-12	1 1/2-12	1 61/64	1 11/16	5/8		1 3/8	2 5/8
2 1/2	3	3 1/8		1	2 1/2-12	2 1/16	2 1/4-12	1 7/8-12	2 29/64	1 15/16	3/4		1 3/4	3 1/4
3	3 1/2	3 3/4		1	3-12	2 5/8	2 3/4-12	2 1/4-12	2 15/16	2 7/16	7/8		2 1/4	3 5/8 (#2)
3 1/2	3 1/2	4 1/4		1	3 1/2-12	3	3 1/4-12	2 1/2-12	3 7/16	2 11/16	1		2 1/2	4 3/8
4	4	4 3/4		1	4-12	3 3/8	3 3/4-12	3-12	3 15/16	2 11/16	1		3	4 1/2
4 1/2	4 1/2	5 1/4		1	4 1/2-12	**	4 1/4-12	3 1/4-12	4 27/64	3 3/16	1 1/2		3 1/2	5 1/4
5	5	5 3/4		1	5-12	**	4 3/4-12	3 1/2-12	4 59/64	3 3/16	1 1/2		3 7/8	5 3/8
5 1/2	5 1/2	6 1/4		1	5 1/2-12	**	5 1/4-12	4-12	5 27/64	3 15/16	1 7/8		4 3/8	6 1/4
7	7	8		1	7-12	**	6 1/2-12	5 1/2-12	6 57/64	4 1/16	2		5 3/4	6 1/2

* Distance across wrench flats.

** (4) Spanner holes 33/64" x 1/2" deep.

Note: Other rod sizes available. Consult factory.

▲ Rod end style KK₂ is studded as standard for 5/8" and 1" diameter rods. Studded rod end style is available for all rod sizes.

■ See page 105 for Series MN piston rod end styles.

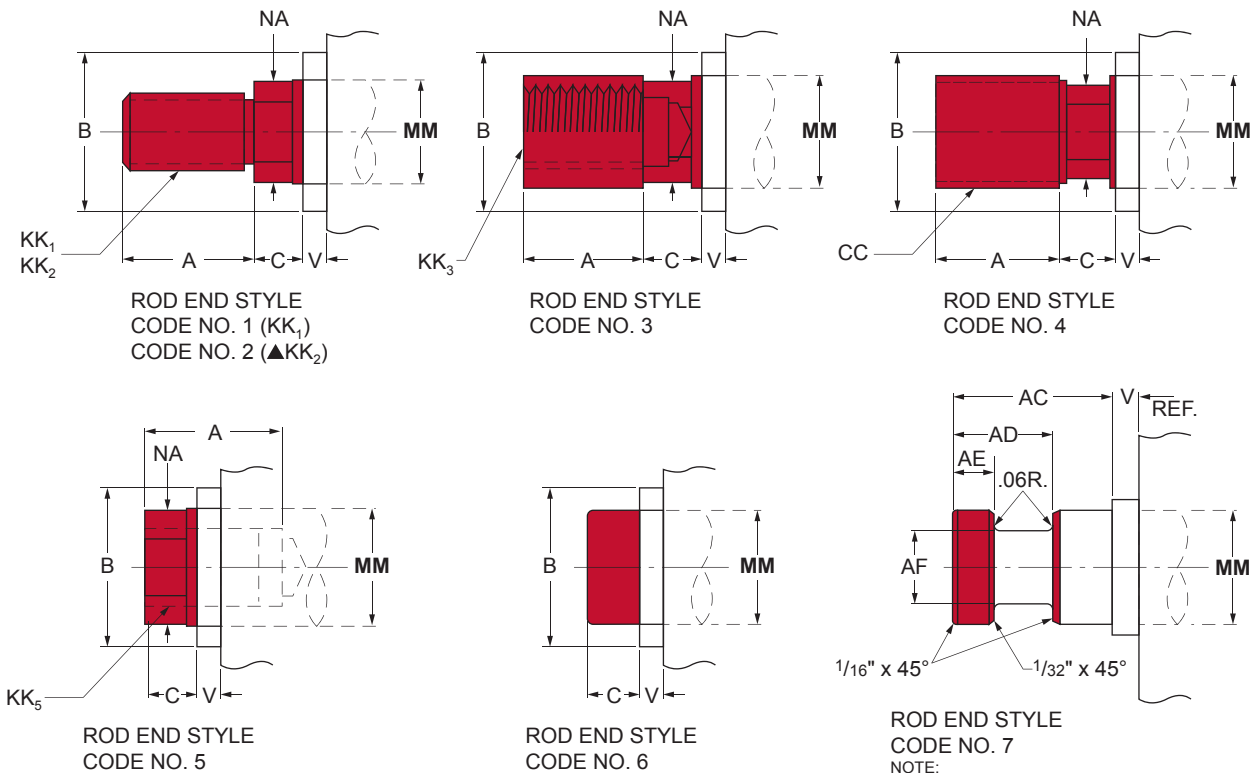

CAUTION: When ordering replacement cylinders for competitive brands, our Style #1 rod ends may not be interchangeable with other manufacturers' Style #1. Our Style #2 should be used if this applies to your application.

METRIC Piston Rod End Styles (Series MH)

Bore Ø	Rod MM	Rod End Styles					Rod End Styles					
		B	V	C	*D	NA	KK ₁	A	KK ₂	A	KK ₅	A
25	12	24	6	9	10	11	M10 X 1.25	14	—	—	M8 X 1	14
	18	30			15	17	M14 X 1.5	18	M10 X 1.25	14	M12 X 1.25	18
32	14	26	12	13	12	13	M12 X 1.25	16	—	—	M10 X 1.25	16
	22	34			18	21	M16 X 1.5	22	M12 X 1.25	16	M16 X 1.5	22
40	18	30	6	19	15	17	M14 X 1.5	18	—	—	M12 X 1.25	18
	28	42			22	26	M20 X 1.5	28	M14 X 1.5	18	M20 X 1.5	28
50	22	34	6	19	18	21	M16 X 1.5	22	—	—	M16 X 1.5	22
	28	42			22	16	M20 X 1.5	28	M16 X 1.5	22	M20 X 1.5	28
	36	50			30	34	M27 X 2	36	M16 X 1.5	22	M27 X 2	36
63	28	42	6	26	22	26	M20 X 1.5	28	—	—	M20 X 1.5	28
	36	50			30	34	M27 X 2	36	M20 X 1.5	28	M27 X 2	36
	45	60			39	43	M33 X 2	45	M20 X 1.5	28	M33 X 2	45
80	36	50	5	26	30	34	M27 X 2	36	—	—	M27 X 2	36
	45	60			39	43	M33 X 2	45	M27 X 2	36	M33 X 2	45
	56	72	9	22	48	54	M42 X 2	56	M27 X 2	36	M42 X 2	56
100	45	60	7	28	39	43	M33 X 2	45	—	—	M33 X 2	45
	36	72			48	54	M42 X 2	56	M33 X 2	45	M42 X 2	56
	70	88	10	25	62	68	M48 X 2	63	M33 X 2	45	M48 X 2	63
125	56	72	7	28	48	54	M42 X 2	56	—	—	M42 X 2	56
	70	88			62	68	M48 X 2	63	M42 X 2	56	M48 X 2	63
	90	108	10	25	80	88	M64 X 3	85	M42 X 2	56	M64 X 3	85
160	70	88	7	25	62	68	M48 X 2	63	—	—	M48 X 2	63
	90	108			80	88	M64 X 3	85	M48 X 2	63	M64 X 3	85
	110	133			**	108	M80 X 3	95	M48 X 2	63	M80 X 3	95
200	90	108	7	25	80	88	M64 X 3	85	—	—	M64 X 3	85
	110	133			**	108	M80 X 3	95	M64 X 3	85	M80 X 3	95
	140	163			**	138	M100 X 3	112	M64 X 3	85	M100 X 3	112

* Distance across wrench flats.

** (4) Spanner holes 13mm x 13mm deep.

Note: Other rod sizes available. Consult factory.

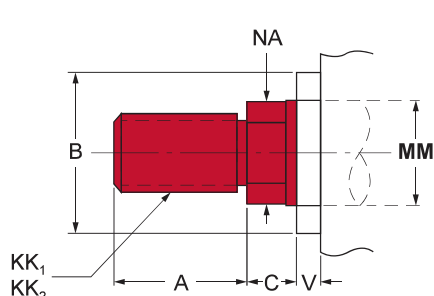

ROD END STYLE
CODE NO. 1 (KK₁)
CODE NO. 2 (KK₂)

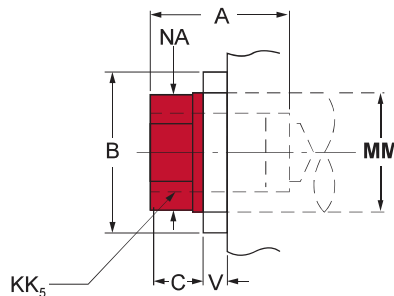

ROD END STYLE
CODE NO. 5 (KK₅)